



Dear customer,

Congratulations on choosing a Noctua NH-L9 cooler for your AM4 system. We always like to think of our coolers as safe long-term investments. Not only are they built to last, we also provide upgrade kits so that you can keep using your trusty Noctua heatsink when you do a system upgrade.

Enjoy your Noctua NH-L9 on AM4!

Yours sincerely,

Roland Mossig, Noctua CEO

This SecuFirm2™ Mounting-Kit for AM4 is compatible with the NH-L9a and NH-L9i. For detailed, up to date compatibility information please visit: [www.noctua.at/am4](http://www.noctua.at/am4)

The NH-L9i has been designed for the Intel LGA115x platform. While it can be installed without any problems on most AM4 motherboards using the NM-AM4-L9aL9i kit, it is possible that it may not fit in some cases. Therefore, please be extra careful when installing the NH-L9i on AM4 and verify that the cooler doesn't press against any other components. Please also see the FAQs on our website for details.

This manual will guide you through the installation process step by step using an NH-L9a heatsink as an example. The installation procedure is identical for the NH-L9i.

Prior to installing the cooler, please consult the compatibility list on our website ([www.noctua.at/compatibility](http://www.noctua.at/compatibility)) and verify that the cooler is fully compatible with your motherboard. In particular, if your motherboard does not come with a pre-installed stock backplate, double check that there are no components on the rear side that would prevent the installation of the NM-ABP4 backplate. Should you encounter any difficulties, please check the FAQs on our website ([www.noctua.at/faqs](http://www.noctua.at/faqs)) and don't hesitate to contact our support team at [support@noctua.at](mailto:support@noctua.at).

Noctua cannot be held responsible for any damage or losses caused by compatibility issues.

Multilingual versions of this manual are available on our website: [www.noctua.at/manuals](http://www.noctua.at/manuals)

### Required mounting parts:

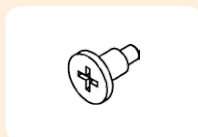
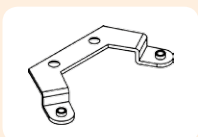
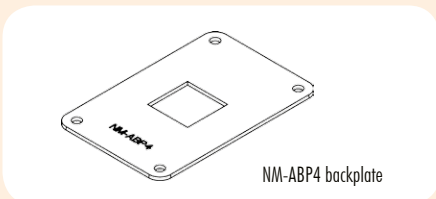

### Step 1

#### Changing the mounting brackets

Unscrew the original NM-AFB5 (NH-L9a) or NM-IFB5 (NH-L9i) brackets and replace them with the supplied NM-AFB6 brackets using the original screws.

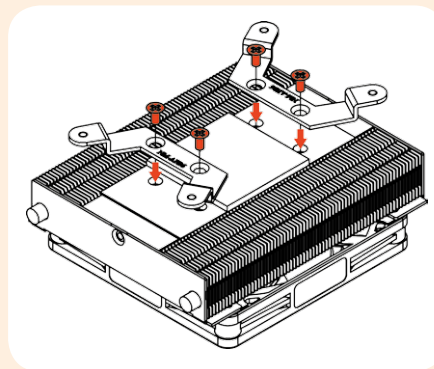

### Step 2

#### Removing the stock retention module and backplate

If your motherboard comes with a pre-installed CPU cooler retention module, please first remove it by unscrewing it from the backplate. Then remove the backplate.

If your motherboard does not come with a pre-installed CPU cooler retention module and backplate, please proceed with step 3.

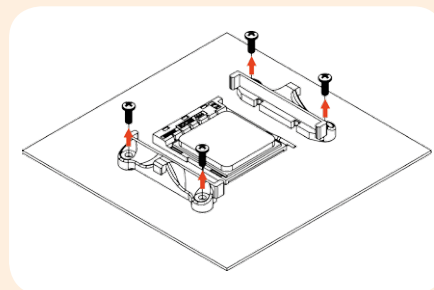

### Step 3

#### Applying thermal paste

If there are residual traces of thermal paste or thermal pads on your CPU, please clean them off first. Then press a small drop (4-5mm diameter) of the supplied NT-H1 thermal compound onto the centre of the heatspreader.

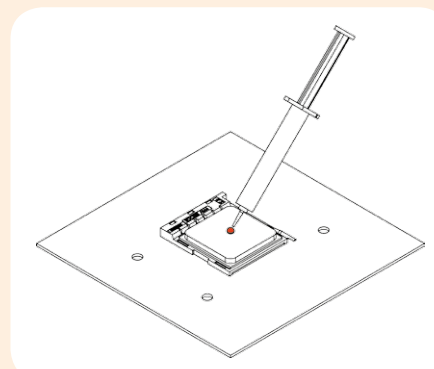

**Caution:** Applying too much thermal paste will lower heat conductivity and cooling performance!

### Step 4

#### Fastening the heatsink to the CPU

Put the heatsink onto the CPU and the supplied NM-ABP4 backplate to the rear side of the motherboard. Now stick the mounting screws through the holes of the backplate and fix the cooler. Perform 3 turns on each screw, then repeat until all are fully tightened.

**Caution:** Please make sure that the insulated side of the backplate is facing the motherboard.

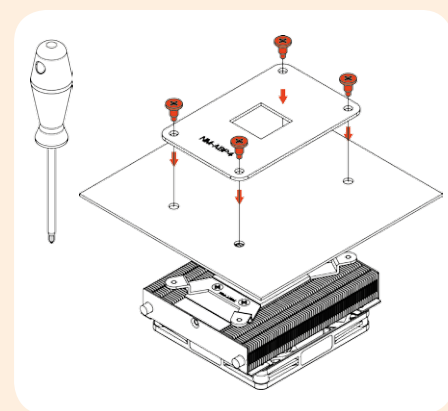

**Caution:** Gently tighten the screws until they stop, but don't use excessive force (max. torque 0.6 Nm).

### Step 5

#### Fan setup

Connect the fan to the motherboard as described in the cooler manual. If you don't have it at hand, you can download it at [www.noctua.at/manuals](http://www.noctua.at/manuals).

#### Warranty, support and FAQs

Even with high-grade products and strict quality control, the possibility of defects cannot be eliminated entirely. Therefore, we aim at providing the highest possible level of reliability and convenience by offering a warranty period of 6 years and direct, fast and straightforward RMA service.

Should you encounter any problems with your Noctua product, please check the FAQs on our website ([www.noctua.at/faqs](http://www.noctua.at/faqs)) and don't hesitate to contact our support team at [support@noctua.at](mailto:support@noctua.at).